

saxun®

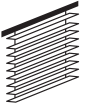

# VENECIANA DE **ALUMINIO**

ALUMINIUM VENETIAN BLIND | VÉNITIEN ALUMINIUM



## COMPONENTES

COMPONENTS | COMPOSANTS

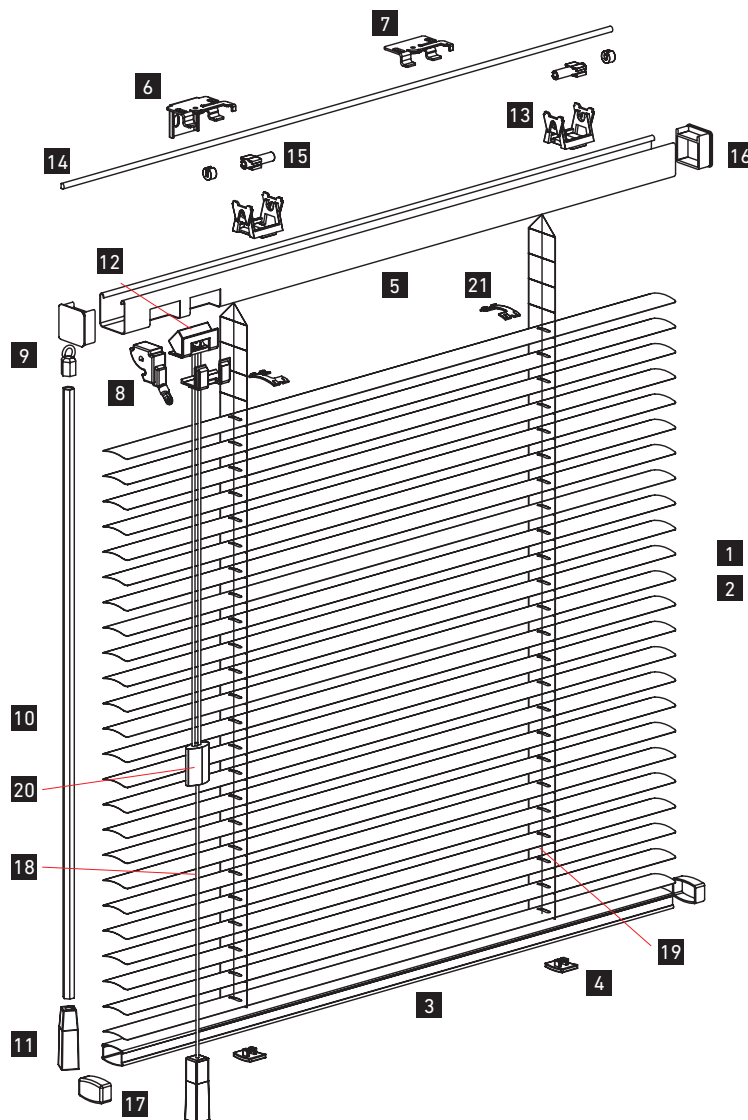

DESCRIPCIÓN DESCRIPTION   DESCRIPTION	CÓDIGO REF.   RÉF.
<b>1</b> Lama aluminio 25 mm Aluminium slat 25 mm   Lame aluminium 25 mm	<b>040028</b>
<b>2</b> Lama aluminio 16 mm Aluminium slat 16 mm   Lame aluminium 16 mm	<b>040000</b>
<b>3</b> Terminal cerrado 25 mm Bottom weight closed 25 mm   Lame finale fermée 25 mm	<b>040002</b>
<b>4</b> Botón riel Rail cap   Butée	<b>040007</b>
<b>5</b> Cabezal 25 Head 25   Tête 25	<b>040001</b>
<b>6</b> Soporte pared/techo Wall/roof bracket   Support mur/plafond	<b>040016</b>
<b>7</b> Soporte techo Roof bracket   Support plafond	<b>040017</b>
<b>8</b> Maquinilla graduar Graduation mechanism   Treuil de graduation	<b>040008</b>
<b>9</b> Gancho varilla mando Rod joining   Crochet baguette de commande	<b>040019</b>
<b>10</b> Varilla mando Rod control   Baguette de commande	<b>040018</b>
<b>11</b> Terminal varilla y cordón Rod and cord counterweight   Final baguette et cordon	<b>040020</b>

DESCRIPCIÓN DESCRIPTION   DESCRIPTION	CÓDIGO REF.   RÉF.
<b>12</b> Maquinilla elevar Move-up mechanism   Treuil d'élévation	<b>040010</b>
<b>13</b> Soporte rodete 25 Bracket 25   Support tortillon 25	<b>040013</b>
<b>14</b> Varilla eje media luna Axle bar   Baguette axe croissante	<b>040015</b>
<b>15</b> Bombo de 25 Drum 25   Tambour de 25	<b>040011</b>
<b>16</b> Tapón cabezal de 25 Cap for head 25   Bouchon tête de 25	<b>040005</b>
<b>17</b> Tapón riel de 25 Cap for bottom weight   Paire d'embouts rail de 25	<b>040006</b>
<b>18</b> Cordón Veneciana 1,4 Cord 1,4   Cordon Vénitien 1,4	<b>040004</b>
<b>19</b> Escalerilla Ladder   Passerelle	<b>040029</b>
<b>20</b> Igualador cordón Cord levelling   Égalisateur corde	<b>040021</b>
<b>21</b> Espaciador Separator   Séparateur	<b>040030</b>

## COMPONENTES

COMPONENTS | COMPOSANTS

Con motor  
With motor  
Avec moteur

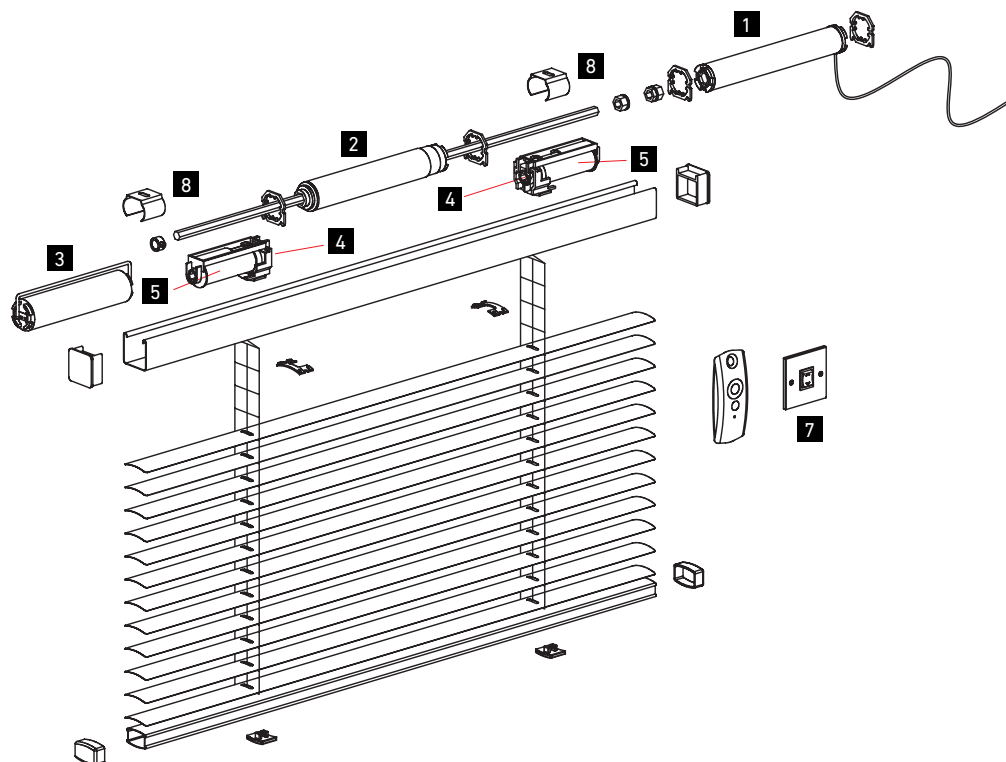

DESCRIPCIÓN DESCRIPTION   DESCRIPTION	CÓDIGO REF.   RÉF.	DESCRIPCIÓN DESCRIPTION   DESCRIPTION	CÓDIGO REF.   RÉF.
<b>1</b> Motor LV25-B64 Motor LV25-B64   Moteur LV25-B64	<b>502443</b>	<b>5</b> Cono hexagonal Hexagonal cone   Cône hexagonal	<b>501785</b>
<b>2</b> Stop mecánico AMS25 AMS25 mechanical stop   Arrêt mécanique AMS25	<b>502733</b>	<b>6</b> Transformador Power station   Récepteur	<b>502555</b>
<b>3</b> Receptor radio Radio receiver   Récepteur radio	<b>501954</b>	<b>7</b> Interruptor Switch   Inverseur	<b>501958</b>
<b>4</b> Cubierta cono Cone covering   Couvre cône	<b>501851</b>	<b>8</b> Soporte entre cristales Bracket between glasses   Support entre vitrage	<b>040033</b>

## ESCUADRAS

SQUARES | ÉQUERRES

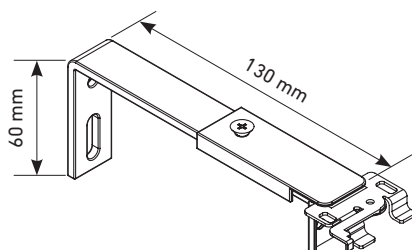

**040079**

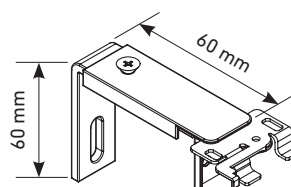

**040078**

## RECOGIDA TIDIED UP | ENCOMBREMENT

<b>Alto</b>   Height   Hauteur	30 cm	60 cm	80 cm	120 cm	160 cm	200 cm	240 cm	280 cm	300 cm
<b>Recogida</b>   Rolling diameter   Encombrement	5,2 cm	5,9 cm	6,4 cm	7,9 cm	8,3 cm	9,3 cm	10,3 cm	11,2 cm	11,7 cm

Medidas orientativas | Estimated sizes | Dimensions approximatives

## SOPORTES

SUPPORTS | SUPPORTS

Sección soporte ventana  
Section window bracket  
Section support fenêtre

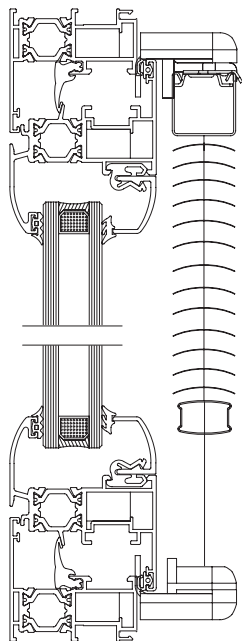

Superior  
Upper  
Supérieur  
030002

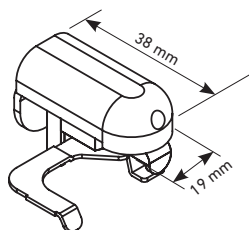

Inferior  
Bottom  
Inférieur  
030003

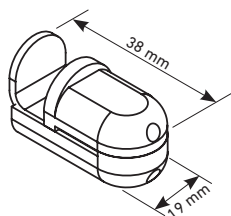

Lama 16  
Slat 16  
Lame 16

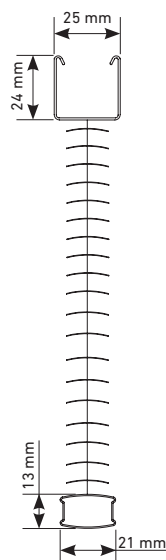

Lama 25  
Slat 25  
Lame 25

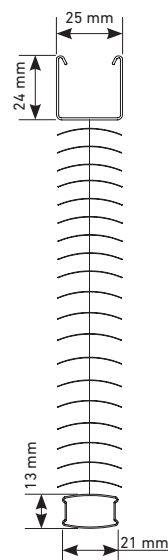

## MODELOS

TYPES | MODÈLES

Monocomando a cadena  
Chain control  
Mono-commande à chaîne

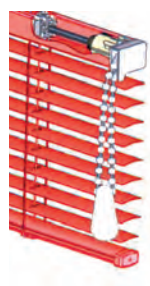

Sujeción final  
Final holding  
Fixation finale



Guiada a cable  
Wire guided  
Guidé par câble

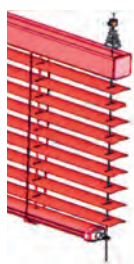

Mando botón  
entre cristales  
Button control  
between glasses  
Commande bouton  
entre vitrage



Mando varilla flexible  
entre cristales  
Flexible rod control  
between glasses  
Commande baguette  
flexible entre vitrage



Gradúa y eleva  
For regulating and moving up  
Oriente et élève

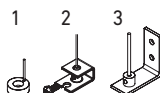

Sólo gradúa  
Only graduates  
Oriente

Gradúa y eleva  
For regulating and moving up  
Oriente et élève

MÁXIMOS  
MAXIMUMS | MAXIMUMS

Ancho | Width | Largeur

-

Alto | Height | Hauteur

-

MÍNIMOS  
MINIMUMS | MINIMUMS

Ancho | Width | Largeur

0,36 m

Alto | Height | Hauteur

0,20 m

\* Según modelo | Depends on type | Selon le modèle

